

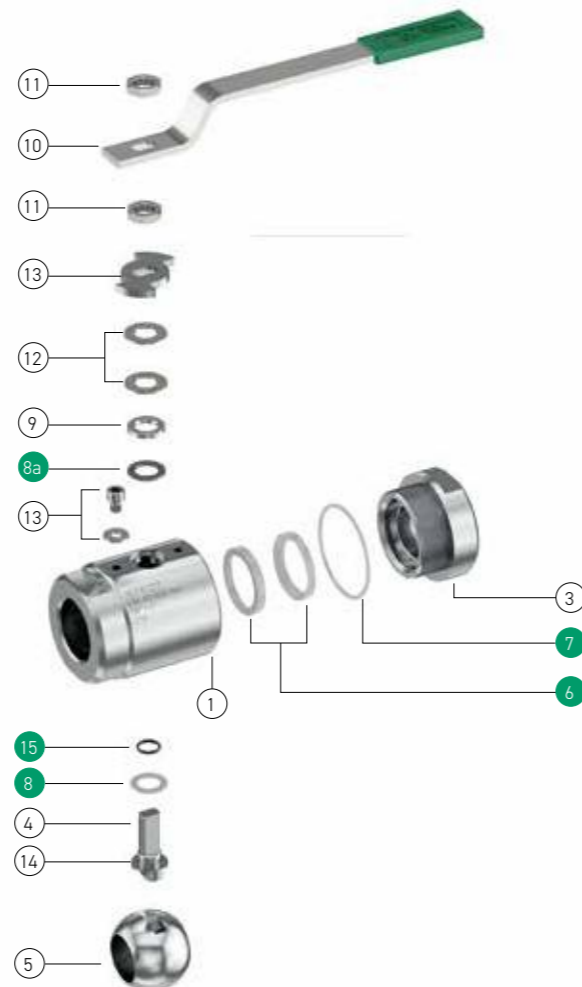

## A20T 800lb screwed body type ball valve - full bore

PART NAME PARTICOLARE	Q.TY Q.TA'	MATERIALS MATERIALI	
1 body corpo	1	ASTM A105N/LF2	ASTM A479 316/316L
3 closure chiusura	1	ASTM A105N/LF2	ASTM A479 316/316L
4 stem stelo	1	ASTM A182 F51	
5 ball sfera	1	ASTM A351 CF8	ASTM A351 CF8M
6 seats sedi	2	TFM	
7 body gasket guarnizione corpo	1	P.T.F.E.	
8 washer bussola	1	P.T.F.E.	
8a stem gasket guarnizione stelo	1	GRAPHOIL	
9 gland premi-guarnizione	1	Carbon steel Zinc Coated	Stainless Steel 316
10 lever leva	1	Carbon steel Zinc Coated	
11 stem nut dado stelo	2	CL8	A4-40 (AISI 316)
12 spring washer molla a tazza	2	51 CrV4 Zinc coated	AISI 316
13 stop device dispositivo di arresto	1	CL. 8.8 Zinc Coated	AISI 316
14 antistatic device dispositivo antistatico	1	AISI 316	
15 stem o-ring o-ring stelo	1	VITON 75 Sh. A	



Spares parts / Parti di ricambio

### STANDARD FEATURES CARATTERISTICHE STANDARD

Flange Facing / Finitura Flange : NPT (ASME B1.20.1)-GAS (ISO 228/1)-BW Sch.80 (ASME B16.25)  
SW (ASME B16.11)

Face to face / Scartamento : Manufacturer standard

Design according to / Progettazione secondo : ASME B16.34, EN 12516-1, EN 17292, PED 2014/68/UE

Fire Safe Design and Construction according to / Costruzione e assemblaggio Fire Safe secondo :  
EN ISO 10497, API 6FA, API 607

Antistatic Device according to / Dispositivo antistatico secondo : BS 5146

Tightness class / Classe di tenuta : VI (FCI 70-2 - ANSI B 16.104)

Stem sealing with O-ring, Anti Blow-out stem / Tenuta stelo con O-Ring, stelo anti-espulsione

### A20T 800lb CARBON STEEL BODY / CORPO ACCIAIO AL CARBONIO

DN	VALVE RATING	VALVE CODE	DESCRIPTION	KIT CODE
06	800lb	A2T06P3CN-0002-M0090	ALFA20T DN06 800lb A105N GAS FS	N.A. (*)
06	800lb	A2T06P3CN-0001-M0090	ALFA20T DN06 800lb A105N NPT FS	N.A. (*)
10	800lb	A2T10P3CN-0002-M0090	ALFA20T DN10 800lb A105N GAS FS	N.A. (*)
10	800lb	A2T10P3CN-0001-M0090	ALFA20T DN10 800lb A105N NPT FS	N.A. (*)
<b>15</b>	<b>800lb</b>	<b>A2T15P3CN-0002-M0090</b>	<b>ALFA20T DN15 800lb A105N GAS FS</b>	<b>KGA2T15P3-001</b>
<b>15</b>	<b>800lb</b>	<b>A2T15P3CN-0001-M0090</b>	<b>ALFA20T DN15 800lb A105N NPT FS</b>	<b>KGA2T15P3-001</b>
15	800lb	A2T15P3CN-0002-M0010	ALFA20T DN15 800lb A105N BW FS	KGA2T15P3-001
15	800lb	A2T15P3CN-0001-M0010	ALFA20T DN15 800lb A105N SW FS	KGA2T15P3-001
<b>20</b>	<b>800lb</b>	<b>A2T20P3CN-0002-M0090</b>	<b>ALFA20T DN20 800lb A105N GAS FS</b>	<b>KGA2T20P3-001</b>
<b>20</b>	<b>800lb</b>	<b>A2T20P3CN-0001-M0090</b>	<b>ALFA20T DN20 800lb A105N NPT FS</b>	<b>KGA2T20P3-001</b>
20	800lb	A2T20P3CN-0002-M0010	ALFA20T DN20 800lb A105N BW FS	KGA2T20P3-001
20	800lb	A2T20P3CN-0001-M0010	ALFA20T DN20 800lb A105N SW FS	KGA2T20P3-001
<b>25</b>	<b>800lb</b>	<b>A2T25P3CN-0002-M0090</b>	<b>ALFA20T DN25 800lb A105N GAS FS</b>	<b>KGA2T25P3-001</b>
<b>25</b>	<b>800lb</b>	<b>A2T25P3CN-0001-M0090</b>	<b>ALFA20T DN25 800lb A105N NPT FS</b>	<b>KGA2T25P3-001</b>
25	800lb	A2T25P3CN-0002-M0010	ALFA20T DN25 800lb A105N BW FS	KGA2T25P3-001
25	800lb	A2T25P3CN-0001-M0010	ALFA20T DN25 800lb A105N SW FS	KGA2T25P3-001
32	800lb	A2T32P3CN-0002-M0090	ALFA20T DN32 800lb A105N GAS FS	KGA2T32P3-001
32	800lb	A2T32P3CN-0001-M0090	ALFA20T DN32 800lb A105N NPT FS	KGA2T32P3-001
<b>40</b>	<b>800lb</b>	<b>A2T40P3CN-0002-M0090</b>	<b>ALFA20T DN40 800lb A105N GAS FS</b>	<b>KGA2T40P3-001</b>
<b>40</b>	<b>800lb</b>	<b>A2T40P3CN-0001-M0090</b>	<b>ALFA20T DN40 800lb A105N NPT FS</b>	<b>KGA2T40P3-001</b>
40	800lb	A2T40P3CN-0002-M0010	ALFA20T DN40 800lb A105N BW FS	KGA2T40P3-001
40	800lb	A2T40P3CN-0001-M0010	ALFA20T DN40 800lb A105N SW FS	KGA2T40P3-001
50	800lb	A2T50P3CN-0002-M0090	ALFA20T DN50 800lb A105N GAS FS	KGA2T50P3-001
50	800lb	A2T50P3CN-0001-M0090	ALFA20T DN50 800lb A105N NPT FS	KGA2T50P3-001

A105N  
(LF2)

(\*) FOR VALVES DN06/DN10 SPARE PARTS KIT WILL NOT BE AVAILABLE - I KIT DI RICAMBIO NON SONO DISPONIBILI PER VALVOLE DN06/10

### A20T 800lb STAINLESS STEEL BODY / CORPO ACCIAIO INOSSIDABILE

DN	VALVE RATING	VALVE CODE	DESCRIPTION	KIT CODE
<b>06</b>	<b>800lb</b>	<b>A2T06P3SD-0002-M0000</b>	<b>ALFA20T DN06 800lb 316/316L GAS FS</b>	<b>N.A. (*)</b>
<b>06</b>	<b>800lb</b>	<b>A2T06P3SD-0001-M0000</b>	<b>ALFA20T DN06 800lb 316/316L NPT FS</b>	<b>N.A. (*)</b>
10	800lb	A2T10P3SD-0002-M0000	ALFA20T DN10 800lb 316/316L GAS FS	N.A. (*)
10	800lb	A2T10P3SD-0001-M0000	ALFA20T DN10 800lb 316/316L NPT FS	N.A. (*)
<b>15</b>	<b>800lb</b>	<b>A2T15P3SD-0002-M0000</b>	<b>ALFA20T DN15 800lb 316/316L GAS FS</b>	<b>KGA2T15P3-001</b>
<b>15</b>	<b>800lb</b>	<b>A2T15P3SD-0001-M0000</b>	<b>ALFA20T DN15 800lb 316/316L NPT FS</b>	<b>KGA2T15P3-001</b>
15	800lb	A2T15P3SD-0004-M0000	ALFA20T DN15 800lb 316/316L BW FS	KGA2T15P3-001
15	800lb	A2T15P3SD-0003-M0000	ALFA20T DN15 800lb 316/316L SW FS	KGA2T15P3-001
<b>20</b>	<b>800lb</b>	<b>A2T20P3SD-0003-M0000</b>	<b>ALFA20T DN20 800lb 316/316L GAS FS</b>	<b>KGA2T20P3-001</b>
<b>20</b>	<b>800lb</b>	<b>A2T20P3SD-0004-M0000</b>	<b>ALFA20T DN20 800lb 316/316L NPT FS</b>	<b>KGA2T20P3-001</b>
20	800lb	A2T20P3SD-0006-M0000	ALFA20T DN20 800lb 316/316L BW FS	KGA2T20P3-001
20	800lb	A2T20P3SD-0005-M0000	ALFA20T DN20 800lb 316/316L SW FS	KGA2T20P3-001
<b>25</b>	<b>800lb</b>	<b>A2T25P3SD-0003-M0000</b>	<b>ALFA20T DN25 800lb 316/316L GAS FS</b>	<b>KGA2T25P3-001</b>
<b>25</b>	<b>800lb</b>	<b>A2T25P3SD-0001-M0000</b>	<b>ALFA20T DN25 800lb 316/316L NPT FS</b>	<b>KGA2T25P3-001</b>
25	800lb	A2T25P3SD-0005-M0000	ALFA20T DN25 800lb 316/316L BW FS	KGA2T25P3-001
25	800lb	A2T25P3SD-0004-M0000	ALFA20T DN25 800lb 316/316L SW FS	KGA2T25P3-001
<b>40</b>	<b>800lb</b>	<b>A2T40P3SD-0002-M0000</b>	<b>ALFA20T DN40 800lb 316/316L GAS FS</b>	<b>KGA2T40P3-001</b>
<b>40</b>	<b>800lb</b>	<b>A2T40P3SD-0001-M0000</b>	<b>ALFA20T DN40 800lb 316/316L NPT FS</b>	<b>KGA2T40P3-001</b>
40	800lb	A2T40P3SD-0004-M0000	ALFA20T DN40 800lb 316/316L BW FS	KGA2T40P3-001
40	800lb	A2T40P3SD-0003-M0000	ALFA20T DN40 800lb 316/316L SW FS	KGA2T40P3-001
50	800lb	A2T50P3SD-0002-M0000	ALFA20T DN50 800lb 316/316L GAS FS	KGA2T50P3-001
50	800lb	A2T50P3SD-0001-M0000	ALFA20T DN50 800lb 316/316L NPT FS	KGA2T50P3-001
50	800lb	A2T50P3SD-0004-M0000	ALFA20T DN50 800lb 316/316L BW FS	KGA2T50P3-001
50	800lb	A2T50P3SD-0003-M0000	ALFA20T DN50 800lb 316/316L SW FS	KGA2T50P3-001

316(L)

(\*) FOR VALVES DN06/DN10 SPARE PARTS KIT WILL NOT BE AVAILABLE - I KIT DI RICAMBIO NON SONO DISPONIBILI PER VALVOLE DN06/10



Product codes in bold are related to product available on stock; delivery time within 3 weeks based on ordered quantity.

All other codes are related to product ready for assembly; delivery time within 5 weeks based on ordered quantity.

Missing Sizes and Special Executions are available upon request. Please contact Sales Dept. for availability and delivery time

I codici in grassetto indicano prodotti normalmente disponibili a stock; consegna entro 3 settimane secondo quantità ordinate

Gli altri codici indicano prodotti disponibili per assemblaggio; consegna entro 5 settimane secondo quantità ordinate

Dimensioni mancanti ed esecuzioni speciali sono disponibili su richiesta. Si prega contattare Ufficio commerciale per disponibilità e consegne